

Read all information and instructions in this document carefully before using the device and keep it for further reference. For more device information and instructions, please refer to other documents (if any) accompanying the device or scan the QR code (if any) on the packaging to get more information.

COPYRIGHT ©2022 Hangzhou Hikfire Technology Co., Ltd. All rights reserved.

About this Document

The document includes instructions for using and managing the Product. Pictures, charts, images and all other information hereinafter are for description and explanation only. The information contained in the document is subject to change, without notice, due to firmware updates or other reasons. Please contact our Customer Service for the latest version of this document.

Please use this document under the guidance of professionals.

Note: The interface varies with the models. Please refer to the product datasheet for details.

Trademarks

HIKFIRE and other Hikfire's trademarks and logos are the properties of Hikfire in various jurisdictions. Other trademarks and logos mentioned are the properties of their respective owners.

DISCLAIMER

TO THE MAXIMUM EXTENT PERMITTED BY APPLICABLE LAW, THIS MANUAL AND THE PRODUCT DESCRIBED, WITH ITS HARDWARE, SOFTWARE AND FIRMWARE, ARE PROVIDED "AS IS" AND "WITH ALL FAULTS AND ERRORS". HIKFIRE MAKES NO WARRANTIES, EXPRESS OR IMPLIED, INCLUDING WITHOUT LIMITATION, MERCHANTABILITY, SATISFACTORY QUALITY, OR FITNESS FOR A PARTICULAR PURPOSE. THE USE OF THE PRODUCT BY YOU IS AT YOUR OWN RISK. IN NO EVENT WILL HIKFIRE BE LIABLE TO YOU FOR ANY SPECIAL, CONSEQUENTIAL, INCIDENTAL, OR INDIRECT DAMAGES, INCLUDING, AMONG OTHERS, DAMAGES FOR LOSS OF BUSINESS PROFITS, BUSINESS INTERRUPTION, OR LOSS OF DATA, CORRUPTION OF SYSTEMS, OR LOSS OF DOCUMENTATION, WHETHER BASED ON BREACH OF CONTRACT, TORT (INCLUDING NEGLIGENCE), PRODUCT LIABILITY, OR OTHERWISE, IN CONNECTION WITH THE USE OF THE PRODUCT, EVEN IF HIKFIRE HAS BEEN ADVISED OF THE POSSIBILITY OF SUCH DAMAGES OR LOSS.

YOU ACKNOWLEDGE THAT THE NATURE OF THE INTERNET PROVIDES FOR INHERENT SECURITY RISKS, AND HIKFIRE SHALL NOT TAKE ANY RESPONSIBILITIES FOR ABNORMAL OPERATION, PRIVACY LEAKAGE OR OTHER DAMAGES RESULTING FROM CYBER-ATTACK, HACKER ATTACK, VIRUS INFECTION, OR OTHER INTERNET SECURITY RISKS; HOWEVER, HIKFIRE WILL PROVIDE TIMELY TECHNICAL SUPPORT IF REQUIRED.

YOU AGREE TO USE THIS PRODUCT IN COMPLIANCE WITH ALL APPLICABLE LAWS, AND YOU ARE SOLELY RESPONSIBLE FOR ENSURING THAT YOUR USE CONFORMS TO THE APPLICABLE LAW. ESPECIALLY, YOU ARE RESPONSIBLE, FOR USING THIS PRODUCT IN A MANNER THAT DOES NOT INFRINGE ON THE RIGHTS OF THIRD PARTIES, INCLUDING WITHOUT LIMITATION, RIGHTS OF PUBLICITY, INTELLECTUAL PROPERTY RIGHTS, OR DATA PROTECTION AND OTHER PRIVACY RIGHTS. YOU SHALL NOT USE THIS PRODUCT FOR ANY PROHIBITED END-USES, INCLUDING THE DEVELOPMENT OR PRODUCTION OF WEAPONS OF MASS DESTRUCTION, THE DEVELOPMENT OR PRODUCTION OF CHEMICAL OR BIOLOGICAL WEAPONS, ANY ACTIVITIES IN THE CONTEXT RELATED TO ANY NUCLEAR EXPLOSIVE OR UNSAFE NUCLEAR FUEL-CYCLE, OR IN SUPPORT OF HUMAN RIGHTS ABUSES.

IN THE EVENT OF ANY CONFLICTS BETWEEN THIS MANUAL AND THE APPLICABLE LAW, THE LATTER PREVAILS.

Table of Contents

Overview	1
1. Package Contents	1
2. Basics	1
Get the EZVIZ App	2
Power on Sensor	2
Self-test	3
Add Your Sensor to EZVIZ	3
Method 1 Add by scanning QR code	3
Method 2 Add by gateway	4
Select Appropriate Location	4
Sensor Installation	5
1. Screw Fixed (Recommended)	5
2. Foam Sticker Fixed	5
Sensor Testing	6
1. Testing Method	6
2. Testing Result	6
Specification	7
Sensor Operations	7
BATTERY INSTALLATION and REPLACEMENT	8
1. Install Battery	8
2. Replace Battery	8
3. Removable Lithium ion Battery(CR14250)	8
Operations on the EZVIZ App	9
1. Live View	9
2. Settings	9
INFORMATION FOR PRIVATE HOUSEHOLDS	10

Overview

1. Package Contents



Smoke Sensor (x1)

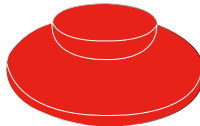

Dust Cap (x1)



Mounting Base (x1)



Battery (x1)



Drill Location Template (x1)



Foam Sticker (x1)



Screw Kit (x1)



Regulatory Information (x2)



Quick Start Guide (x1)

i All device's appearances are subject to the one you have bought.

2. Basics

With ZigBee communication protocol supported, Smoke Sensor (hereafter referred to as Sensor) can trigger a sound-light alarm when detects smoke, fire disaster and other dangerous situations, and then report alarm information via gateway. The Sensor can be widely applied to various scenarios like stores, residence, hotel, high-rise buildings and etc.

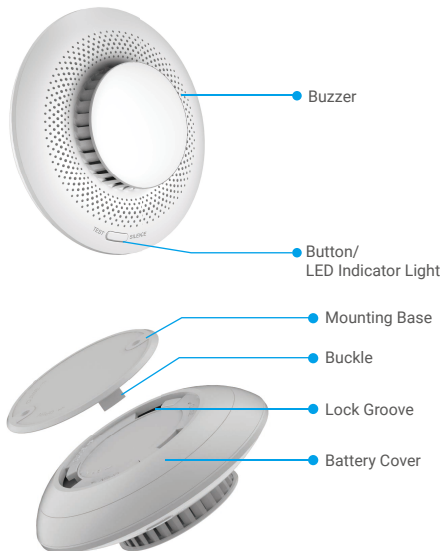

Device Conditions	LED Indicator Light	Buzzer
Fire Alarm	Fast-flashing red	Rapid beeps
Online Standby	Flash green once every 90s	Disable
Offline Standby	Light off	Disable
Sensor Exception	Fast flash yellow twice every 40s	Two beep sounds every 40s
Low Voltage	Fast flash yellow once every 40s	One beep sound with flashing
Device Powered on	Light off	One beep sound
Network Configuration by pressing button	Fast flash green	Disable
Self-test	Flash red, green and yellow alternatively for two rounds	5 beep sounds

Get the EZVIZ App

1. Connect your mobile phone to Wi-Fi (suggested).
2. Download and install the EZVIZ app by searching for "EZVIZ" in the App Store or Google Play™.
3. Launch the app and register an EZVIZ user account.

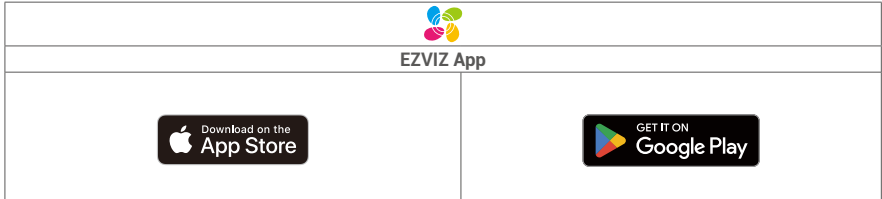

- i** If you have already used the app, please make sure that it is the latest version. To find out if an update is available, go to the app store and search for "EZVIZ".

Power on Sensor

1. Remove the battery cover by rotating along the **OPEN** mark direction on battery cover.

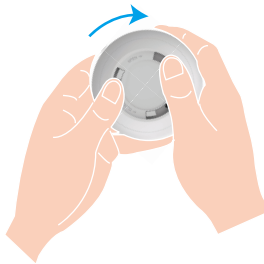

2. Remove the plastic insulated bag of the battery, and then install the battery according to anode and cathode marks.

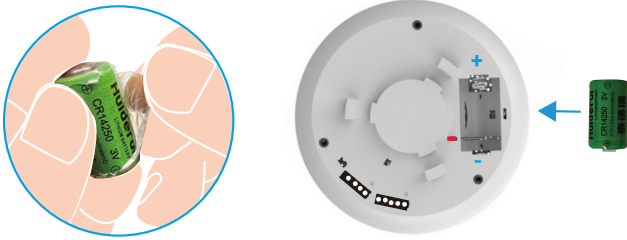

3. Install the battery cover by rotating along the **CLOSE** mark direction on battery cover.



i If you need to replace the battery, please purchase one CR14250 Li-Mn battery.

Self-test

After install or replace the battery, test the Sensor before installation to ensure that the buzzer and LED indicator light are in good conditions. If not, please contact the supplier in time.

Add Your Sensor to EZVIZ

Method 1 Add by scanning QR code

1. Log in to your account through EZVIZ app, tap the device adding icon and then the QR code scanning interface will be displayed.
2. Scan the QR code at the bottom of the Sensor or on the cover of the user manual.



3. Add the sensor by following the wizard on the app.

Method 2 Add by gateway

1. Press the function key of the gateway once to make the gateway enter device adding mode, and the LED indicator ring is in slow-flashing white.
2. Press and hold the Button of the Sensor for 5s to make the Sensor enter network configuration mode, and the LED indicator light is fast-flashing.
3. There will be a voice prompt reminding you that the Sensor has been added to the gateway automatically, or you can view the added Sensor on your EZVIZ APP.

- If the LED indicator light is fast-flashing green for 3 mins, which means the Sensor is failed to be added to the gateway, please repeat the above steps again.
- If you want to delete the Sensor, please choose either of the following methods to clear the matching relationship between the Sensor and the gateway:
 - Enter detailed page of the Sensor on your EZVIZ APP, and then delete the Sensor;
 - Press and hold the Button of the Sensor for 5s to reset and then delete the Sensor from the gateway.

Select Appropriate Location

Installation Cautions

- Please strictly refer to the installation ways of the user manual to install your sensor.
- To avoid the happenness of dangers, please fix the sensor securely when install it on walls or ceilings.
- Please ensure that all components includes the sensor inside of the package are in good conditions
- There should be multiple sensors when the length of the installation location (like ceiling) is greater than 10 meters.
- Please install the Sensor after finish your indoor decoration, for fear that the Sensor is polluted by the environment.
- The installation parameters are subject to EN 14604:2005/AC:2008.
- Do not install the Sensor on the following locations:
 - High-humidity spaces like kitchen, water heater, bathroom;
 - High-temperature and pollution-prone places like stoves;
 - Severe convection places like air-conditioners, fans, heating outlet;
 - Object shelters;
 - Dusty, nasty places or places with many insects;
 - Places with a distance of less then 1.5 meters from the light;
 - Dead-air spaces like top of house with spire and house corners.

1. For Flat Roof

The edge of the Sensor should be at least 500mm away from any wall.

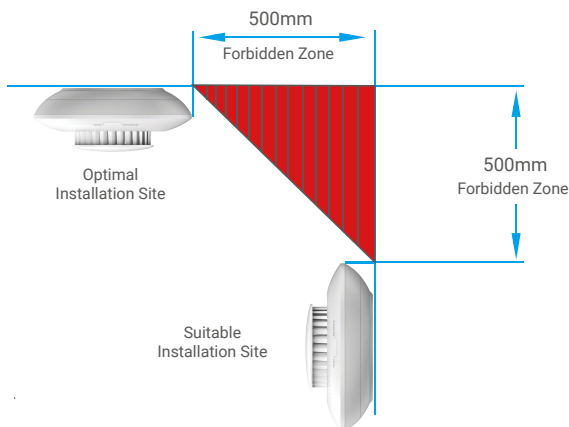

2. For Sloped or Diamond-shaped Roof

The Sensor should be kept at a certain distance from the roof; when the roof slope is less than 30 degrees, the appropriate distance is 500mm.

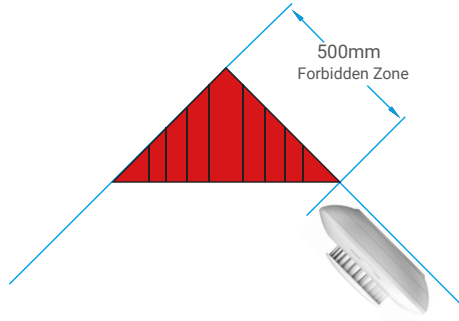

Sensor Installation

1. Screw Fixed (Recommended)

1. Stick the drilling template onto a clean and flat ceiling surface.
2. (For cement wall only) Drill screw holes according to the template, and insert anchors.
3. Align the U-shaped holes corresponded to the amounting base to anchors, and then fix the mounting base with the screws.
4. Rotate the Sensor clockwise to completely lock the buckles of the Sensor and the lock grooves on the mounting base.
5. The installation is finished.

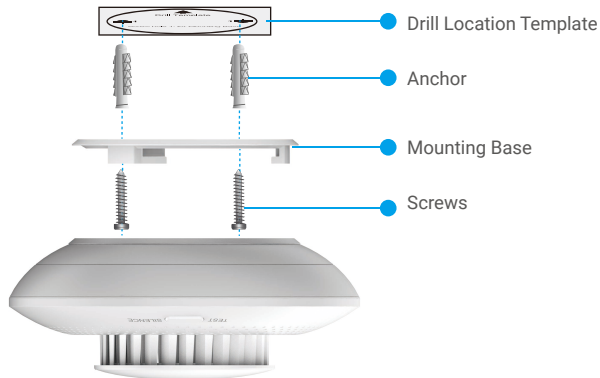

2. Foam Sticker Fixed

1. Paste the foam sticker on the mounting base.
2. Remove the protect film on the foam sticker to fix the mounting base on the ceiling surface.
3. Rotate the Sensor clockwise to completely lock the buckles of the Sensor and the lock grooves on the mounting base.
4. The installation is finished.

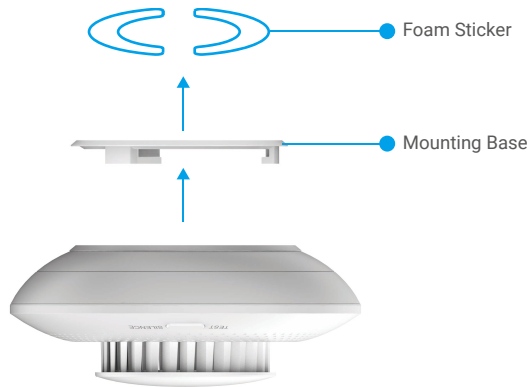

Sensor Testing

1. Testing Method

Put the litten cigarette or other smoke-producing items close to the Sensor, make the smoke into the inlet hole of the Sensor till the Sensor triggers an alarm.



2. Testing Result

After the smoke reaches a specified concentration, the Sensor will trigger an alarm, and the LED indicator light will fast-flashing red and the buzzer will beep for a long time.

- i** After the testing is finished, you can blow the smoke inside of the Sensor inlet holes away to lower the smoke concentration, and then the Sensor will stop alarming and resume to standby state.

Specification

Parameters	Descriptions
Model	CS-T4C
Name	Smoke Sensor
Product Implementation Standard	EN 14604:2005; EN 14604:2005/AC:2008
Working Principle	Photoelectric Type
Communication Mode	ZigBee
Alarm Volume	≥ 85dB@3m (A-weighted)
Local Alarm Mode	Sound-light Alarm
Working Voltage	DC 3V, Lithium Battery CR14250
Standby Current	≤ 15μA
Average Alarm Current	≤ 35 mA
Working Temperature	- 10℃ ~ 55℃
Working Humidity	Relative Humidity:≤95%
Battery Service Life	3 years (The battery service life may be shorten due to actual using situations.)
Size(Diameter*height)	Φ87mm x H35mm

Sensor Operations

Smoke Alarm

In standby mode, when the smoke particles in the smoke sensor reach a specified concentration, the alarm enters the alarm mode.

Alarm mode: The buzzer will beep, and the LED indicator flashes red quickly.

Silence

In alarm mode, short press the Button to silent the alarm(the hush period is 10 minutes.)

Note: after the alarm is silenced, if the smoke concentration that caused the alert continues, the alarm will reactive in 10 minutes.

Reset

When in hush mode, short press the Button, and the alarm resumes to the standby mode.

in alarm mode, if the smoke dissipates, the alarm mode will be deactivated and the alarm will automatically resume to the standby mode.

Test

Check whether the buzzer and LED indicator light are working properly or not.

in standby mode, short press the Button, the alarm enters the test mode.

Test mode: The buzzer beeps for 5 times, and the indicator light alternatively flashes red, green and yellow for two times, which indicates that the buzzer and the LED indicator are working properly.

BATTERY INSTALLATION and REPLACEMENT

1. Install Battery

Tear off the battery insulation, put the battery into the baseplate and insert it to the end.

2. Replace Battery

Remove the battery from baseplate and replace battery with the Lithium Battery CR14250 purchased by a regular manufacturer. Test the device for correct operation whenever the batteries are replaced after re-fitting the device onto the base plate. If the device is not working properly, please add the device and configurate the network again by following the steps in Setup part or directly contact our technical support.

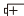

- Risk of explosion if the battery is replaced by an incorrect type.
- Improper replacement of the battery with an incorrect type may defeat a safeguard (for example, in the case of some lithium battery types).
- Do not dispose of the battery into fire or a hot oven, or mechanically crush or cut the battery, which may result in an explosion.
- Do not leave the battery in an extremely high temperature surrounding environment or extremely low air pressure, which may result in an explosion or the leakage of flammable liquid or gas.
- Dispose of used batteries according to the instructions.
-  identifies the battery holder itself and identifies the positioning of the cell(s) inside the battery holder.
- "+" identifies the positive terminal(s) of device which is used with, or generates direct current, "-" identifies the negative terminal(s) of device which is used with, or generates direct current.

3. Removable Lithium ion Battery(CR14250)

Component	Material	CAS No.	Contents
Positive electrode	Manganese Dioxide	1313-13-9	25-35wt%
Negative electrode	Lithium metal	7439-93-2	2-3.5wt%
Electrolyte	1,2-dimethoxyethane	110-71-4	3-5wt%
	organic solvent	-	8-16wt%
Others(Seel or Plastic parts)	Steel	7439-89-6	35-45wt%
	Polypropylene	9003-07-0	0.3-10wt%

Operations on the EZVIZ App

 The app interface may be different due to version update, and the interface of the app you installed on your phone shall prevail.

1. Live View

When you launch the EZVIZ app, you can manage your device as needed on the homepage.

Alarm Message Notification	When detects the following abnormal events, the alarm message will be sent to APP via the gateway: <ul style="list-style-type: none">• Smoke alarm/ alarm reset• Low battery voltage• Device exception
Share	You can share the device to your family members or guests.
Settings	Click this icon, you can perform function settings and general settings.
Device Log	You can view recent device logs here.
Dismiss	When in alarm mode, you can clear the alarm by pressing the Dismiss button in the APP homepage.

2. Settings

Parameter	Description
Device Name	Customize the name of your device.
Linkage camera	Tap to link available device nearby.
Intelligent Linkage	You can add new routine here.
Link Device	You can see linked gateway here.
Device Information	You can see the device information here.
Share the Device	You can share the device to your family members or guests.
Delete Device	Tap to delete the gateway from EZVIZ cloud.

INFORMATION FOR PRIVATE HOUSEHOLDS

1. Separate collection of waste equipment: Electrical and electronic equipment that has become waste is referred to as waste equipment. Owners of waste equipment must dispose of it separately from unsorted municipal waste. In particular, waste equipment does not belong in household waste, but in special collection and return systems.
2. Batteries and rechargeable batteries as well as lamps: Owners of waste equipment shall, as a rule, separate waste batteries and rechargeable batteries that are not enclosed in the waste equipment, which can be removed from the waste equipment without being destroyed, from the waste equipment before handing them in at a collection point. This does not apply if waste equipment is prepared for reuse with the participation of a public waste management authority.
3. Options for returning waste equipment: Owners of waste equipment from private households can return it free of charge to the collection points of the public waste management authorities or to the take-back points set up by manufacturers or distributors within the meaning of the Electrical and Electronics Equipment Law. Stores with a sales area of at least 400 m² for electrical and electronic equipment and those grocery stores with a total sales area of at least 800 m² that offer electrical and electronic equipment several times a year or on a permanent basis and make it available in the market are required to take it back. This also applies in the case of distribution using means of distance communication, if the storage and shipping areas for electrical and electronic equipment are at least 400 m² or the total storage and shipping areas are at least 800 m². Distributors shall, in principle, ensure take-back by providing suitable return facilities at a reasonable distance from the respective end user. The possibility of returning waste equipment free of charge exists for distributors who are obliged to take it back, among other things, if a new similar device that essentially fulfills the same functions is delivered to an end user.
4. Privacy Notice: Waste equipment often contains sensitive personal data. This applies in particular to devices of information and telecommunications technology such as computers and smartphones. In your own interest, please note that each end user is responsible for deleting the data on the waste equipment to be disposed of.
5. Meaning of the symbol “crossed-out wheelee bin”: The symbol of a crossed-out wheelee bin regularly depicted on electrical and electronic equipment indicates that the respective device is to be collected separately from unsorted municipal waste at the end of its service life.